

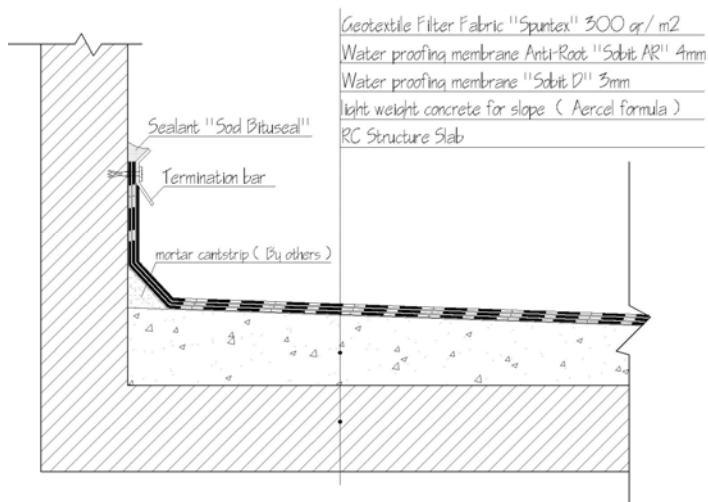

Landscape Waterproofing - The Village - Cairo

Project Name: The Village
Scope: Roofing System
City: Cairo
Country: Egypt
Main contractor: Palm Hills for Development
Vandex Applicator: Sodeco Specialties S.A.E
Construction Period: 2011



Technical Information

Products Used: Aercel Formula
 Soprime WB
 Sobit A
 Spuntex - Geotextile
 HDPE – 400micron
 Drentex Protect 80

Areas Treated: 7000 m²

❖ **Aercel Formula**

1. Light weight concrete up to 400kg/m³
2. Insulating screeding material
3. Effective slopes for proper drainage
4. Fireproof concrete
5. High compressive strength up to 29kg/cm²
6. Average thickness will be 7cm

❖ **Soprime WB**

A non-toxic water-based bitumen primer. It is used as primer coat.

❖ **Sobit A**

Modified APP torch applied bituminous waterproofing membrane

❖ **Geotextile**

A non-woven polypropylene geotextile layer.

Roofing System

❖ **Leveling screed/light weight concrete.**

Leveling Screed will be poured on flat concrete area of the roof using light weight foam cellular concrete laid to (1.0%) positive slopes towards the roof water outlets, with 70mm average thickness. 400 – 500 kg/m³ average dry density, smoothly finished, using " Aercel formula" foaming agent.

❖ **Water based bituminous primer.**

Install one coat of water based bituminous primer "Soprime WB" with a rate of 0.3Lt. /m²

❖ **Bituminous WP membrane**

Install double layer of APP modified bituminous waterproofing membrane the first layer using "Sobit A" 4mm, polyester reinforced and the second layer using "Sobit AR" 4mm, polyester reinforced protected with mineral grey slate finish.

❖ **Separation Layer.**

Install one layer of Separation layer using "spuntex geotextile" 300gm/m² loose laid.

❖ **Vapour Barrier Layer**

Install one layer of Vapour barrier layer using "Polyethylene sheet" 400 micron thick loose laid.

❖ **Drainage layer**

Install one layer of Drainage layer using "Drentex protect 80"

❖ **Filter fabric layer**

Install 1 layer of Filter fabric layer using "spunex geotextile" 500gm/m² loose laid

❖ **Termination of Membrane Skirting Upper Ends**

Aluminum metal flashing 1.0mm thick, 50mm total girth mechanically fixed top edge to be sealed with "Bituseal"

